



2026 Vicki Wilson Championship Preliminary Round

MET West
Friday 5th June, 2026
Western Districts Netball Association
Waratah Avenue, Leybourne St, Graceville QLD 4075

Brought to you by



SCHOOLS COMPETING:

Bremer State High School
Brigidine College
Brisbane Christian College
Calamvale Community College
Centenary State High School
Corinda State High School
Emmaus College, Jimboomba
Faith Lutheran College Plainland
Forest Lake State High School
Glenala State High School
Indooroopilly State High School
Ipswich Girls' Grammar School
Macgregor State High School
Ripley Valley Secondary College
Sophia College
St Aidan's Anglican Girls' School
St Augustine's College, Augustine Heights
St Mary's College, Ipswich
St Peter Claver College
St Peters Lutheran College
St Peters Lutheran Springfield
St Philomena School
St Thomas More College
Stretton State College
Stuartholme School
Sunnybank State High School
The Springfield Anglican College
West Moreton Anglican College
Westside Christian College
Woodcrest State College

**All teams must submit a completed team list prior to the commencement of the preliminary round.
A copy of the team list template has been provided.**

PRELIMINARY ROUND RULES:

1. In order for a school's team to be eligible for the preliminary round, they MUST supply ONE UMPIRE PER TEAM. The umpire cannot be a student playing in a team and one umpire cannot umpire more than one team. In the event of a team participating in a game without providing an umpire the team will be forced to forfeit the game with the score being recorded as "10-0" against the forfeiting team. However, the game may still take place.
2. All players from one team must wear the same netball uniform.
3. Schools should ensure that they have two sets of different coloured bibs at all matches to overcome the problem of schools having uniforms that too closely resemble each other. In such an event, a coin toss prior to the match will determine the team that will choose the colour of bib they will wear.
4. **Games will be scored using LiveScoring on Netball Connect.**
5. Each team must supply one (1) scorer for each game, who is to position themselves with the opposing team's scorer for the duration of the match.
6. It will be the listed HOME team's responsibility to score the games using NetballConnect and the AWAY team's responsibility to monitor the scoreboard (if applicable).
7. Coaches and Scorers for the game will be required to confirm the scores at the completion of the game.
8. A qualified First Aid Officer will be present at the Preliminary Round. Refer to map provided as to where they are located.
9. Preliminary Round is centrally timed – no injury time will be added.
10. Rolling substitutions apply: a player may substitute at any time, as long as they step off the court to do so. Time will not be held for rolling substitutions.
11. The duration of the Preliminary Round matches is at the discretion of Netball Queensland and the Regional Coordinator/s, based on the number of teams entered in the region and court availability.
12. NO JEWELLERY is allowed. All fingernails are to be cut short. Soft brim hats permitted.
13. All games will comprise of 10-minute halves with 2 minutes for half time and 3-minutes between each game.
14. 2 points will be awarded for a win, 1 for a draw and 0 for a loss.
15. Games will commence at 8:25am and finish at 4:20pm.
16. If teams are on equal points at the end of preliminary rounds, the following rules will be applied to differentiate the teams.
 - a. Goal average will determine teams for playoffs. $\text{Numbers of goals scored} / \text{Number of goals against} \times 100 = \% \text{ (to two decimal places)}$.
 - b. If after ranking teams according to goal average to two (2) decimal places, teams remain tied, the results of the match between the two (2) teams concerned during the preliminary rounds will decide the winner.
 - c. If the two (2) teams drew their match or won one (1) match each, or if more than two (2) teams have the same number of points and percentage at the end of the preliminary rounds, then goal difference will be applied (the difference between goals for and goals against).
 - d. In the event of a further tie, the team scoring the most goals during the preliminary round will secure the higher-ranking position.
 - e. If the teams are still at a further tie, the team with the biggest margin of victory in a single match throughout the preliminary round against any of their opponents will decide the winner.
 - f. In the event of a further tie, a coin toss will decide the winner.
 - g. There will be a Managers meeting prior to the games at 8:00am in front of the clubhouse.

VENUE MAP:

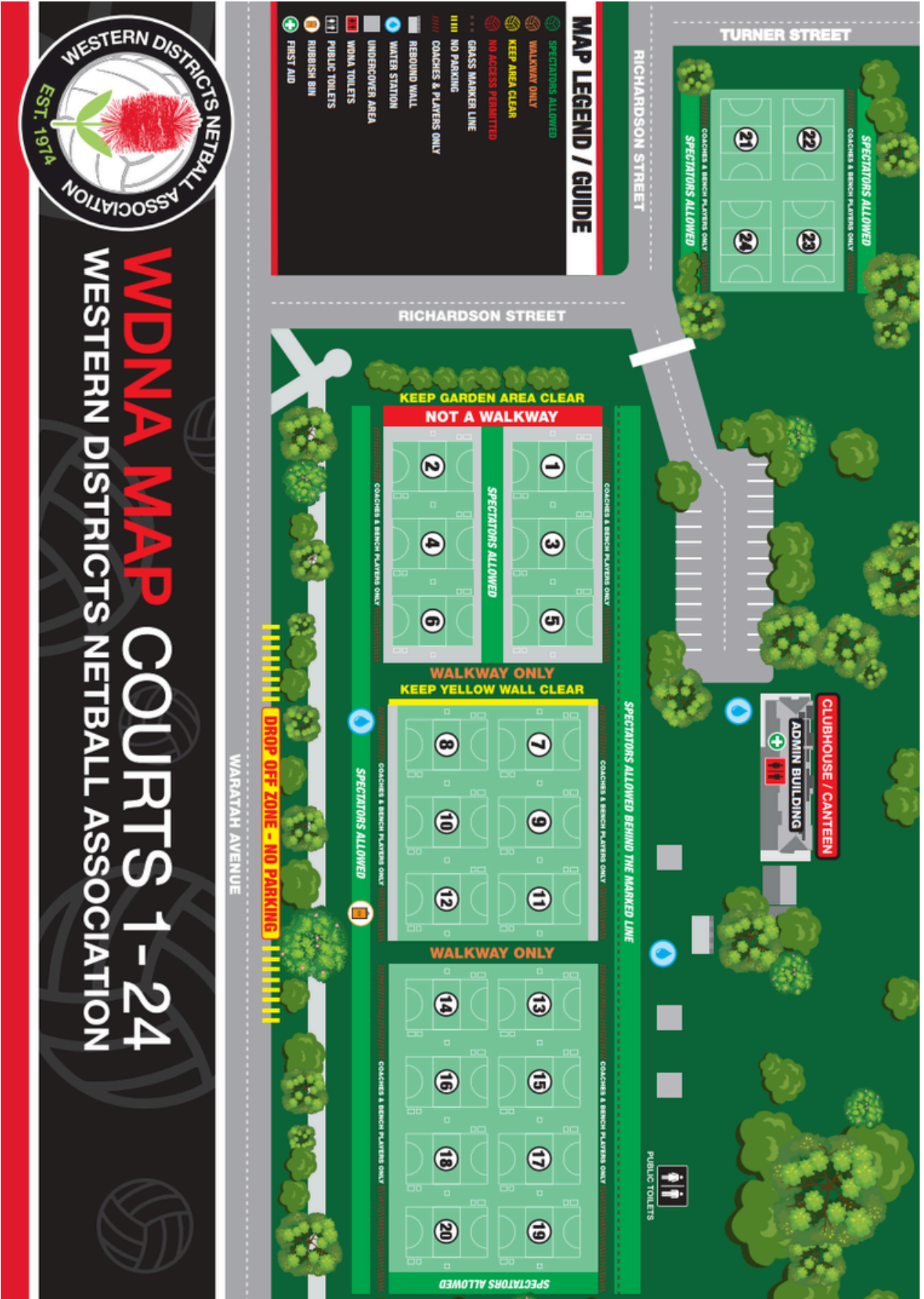

COMPETITION DRAW:

The 2026 Vicki Wilson Championship Preliminary Round - MET West Region draw is now LIVE on Netball Connect. The draw can be found by following the link below or via the Netball Connect app - [Netball Connect | Netball Queensland - 2025 Vicki Wilson Championship Preliminary Round - MET West | Draw](#)

COMPETITION LADDER:

The 2026 Vicki Wilson Championship Preliminary Round - MET West Region ladder can be found by following the link below or via the Netball Connect app - [Netball Connect | Netball Queensland - 2026 Vicki Wilson Championship Preliminary Round - MET West | Ladder](#)

BOYS OPEN CHAMPIONSHIP

(ALPHABETICAL ORDER)

	BOYS OPEN CHAMPIONSHIP
1	Centenary SHS (B)
2	Corinda SHS (B)
3	Faith Lutheran College (B)
4	Glenala SHS (B)
5	Indooroopilly SHS (B)
6	St Peter Claver College (B)
7	St Thomas More College (B)
8	Stretton State College (B)
9	Sunnybank SHS (B)

CUP CHAMPIONSHIP

(ALPHABETICAL ORDER)

	POOL A	POOL B
1	Brisbane Christian College (CC)	Centenary SHS (CC)
2	Glenala SHS (CC)	Corinda SHS (CC)
3	Indooroopilly SHS (CC)	Forest Lake SHS (CC)
4	St Aidan's (CC)	Ipswich Girls' Grammar School (CC)
5	St Peter Claver College (CC)	St Augustine's College (CC)
6	St Peters Indooroopilly (CC)	St Mary's College Ipswich (CC)
7	Stuartholme School (CC)	St Thomas More College (CC)
8	The Springfield Anglican College (CC)	Stretton State College (CC)
9		West Moreton Anglican College (CC)

CUP DEVELOPMENT

(ALPHABETICAL ORDER)

	CUP DEVELOPMENT
1	Calamvale Community College (CD)
2	Emmaus College Jimboomba (CD)
3	Faith Lutheran College (CD)
4	MacGregor SHS (CD)
5	Ripley Valley (CD)
6	Sophia College (CD)
7	St Peters Springfield (CD)
8	St Philomena School (CD)
9	Stuartholme School (CD)

SHIELD CHAMPIONSHIP

(ALPHABETICAL ORDER)

	POOL A	POOL B
1	Bremer SHS (SC)	Brisbane Christian College (SC)
2	Centenary SHS (SC)	Corinda SHS (SC)
3	Ipswich Girls' Grammar School (SC)	Glenala SHS (SC)
4	St Aidan's (SC)	Indooroopilly SHS (SC)
5	St Mary's College Ipswich (SC)	St Peters Indooroopilly (SC)
6	St Thomas More College (SC)	Stuartholme School (SC)
7	Stretton State College (SC)	West Moreton Anglican College (SC)

SHIELD DEVELOPMENT

(ALPHABETICAL ORDER)

	POOL A	POOL B
1	Calamvale Community College (SD)	Faith Lutheran College (SD)
2	Forest Lake SHS (SD)	MacGregor SHS (SD)
3	Indooroopilly SHS (SD)	Sophia College (SD)
4	Ripley Valley (SD)	St Peter Claver College (SD)
5	St Philomena School (SD)	St Peters Springfield (SD)
6	Stuartholme School (SD)	West Moreton Anglican College (SD2)
7	West Moreton Anglican College (SD1)	Westside Christian College (SD2)
8	Westside Christian College (SD1)	Woodcrest State College (SD)

GAME STRUCTURE

- 10-minute halves
- 2-minute half time
- 3-minutes between games

FINAL PLACING GAMES: EXTRA TIME GAME STRUCTURE

- 1-minute break
- 4-minute halves
- 1-minute half time

If scores are still tied at the end of the 2nd half of extra time, the game will continue until one team takes a two-goal lead.

COMPETITION STRUCTURES

BOYS OPEN CHAMPIONSHIP

The Boys Open Championship division will play each team once. After round-robin games have been played, teams will be moved into Playoffs to determine Final Placings:

3:55pm:

Final Placings: 1st Place - Position 1 on the Ladder v Position 2 on the Ladder (Winner to progress to the VW Finals Series)

Final Placings: 3rd Place - Position 3 on the Ladder v Position 4 on the Ladder

Final Placings: 5th Place - Position 5 on the Ladder v Position 6 on the Ladder

Final Placings: 7th Place - Position 7 on the Ladder v Position 8 on the Ladder

Final Placings: 9th Place - Position 9 on the Ladder

CUP CHAMPIONSHIP

The Cup Championship division has been split into one (1) pool of 8 (Pool A) and one (1) pool of 9 (Pool B).

Teams in Pool A will play 7 pool games and teams in Pool B will play 8 pool games. After pool games have been played, teams will be moved into Playoffs to determine Final Placings:

3:55pm:

Semi-Final 1 - A 1 v B 2 (Winner to progress to the VW Finals Series)

Semi-Final 2 - A 2 v B 1 (Winner to progress to the VW Finals Series)

Final Placings: 5th Place - A 3 v B 3

Final Placings: 7th Place - A 4 v B 4

Final Placings: 9th Place - A 5 v B 5

Final Placings: 11th Place - A 6 v B 6

Final Placings: 13th Place - A 7 v B 7

Final Placings: 15th Place - A 8 v B 8

Final Placings: 17th Place - B 9

CUP DEVELOPMENT

The Cup Development division will play each team once. Final Placings will be determined by Ladder Positions at the end of the Preliminary Round.

SHIELD CHAMPIONSHIP

The Shield Championship division has been split into two (2) pools of 7.

Teams will play 6 pool games. After pool games have been played, all teams will be moved into Playoffs to determine Final Placings:

2:40pm:

Semi-Final 1 - A 1 v B 2 (Winner to progress to the VW Finals Series)

Semi-Final 2 - A 2 v B 1 (Winner to progress to the VW Finals Series)

Final Placings: 5th Place - A 3 v B 3

Final Placings: 7th Place - A 4 v B 4

Final Placings: 9th Place - A 5 v B 5

Final Placings: 11th Place - A 6 v B 6

Final Placings: 13th Place - A 7 v B 7

SHIELD DEVELOPMENT

The Shield Development division has been split into two (2) pools of 8.

Teams will play 7 pool games. After pool games have been played, teams will be moved into Playoffs to determine Final Placings:

3:30pm:

Final Placings: 1st Place - A 1 v B 1

Final Placings: 3rd Place - A 2 v B 2

Final Placings: 5th Place - A 3 v B 3

Final Placings: 7th Place - A 4 v B 4

Final Placings: 9th Place - A 5 v B 5

Final Placings: 11th Place - A 6 v B 6

Final Placings: 13th Place - A 7 v B 7

Final Placings: 15th Place - A 8 v B 8

COMPETITION CONTACT

Tahu Whaanga (Competitions Coordinator) - competitions@netballq.org.au